

- NOTES:
- 1 All pipes through external walls are to be protected by an arch or a lintel.
 - 2 Vitrified clay pipes to have flexible joints and bedded in granular material.
 - 3 Details of shower waste to be as standard drawing DEED/G/60-2.
 - 4 Levels shown thus * are interpolated.
 - 5 All redundant foul drainage below ground pipework is to be removed or fully grouted up.
 - 6 New manhole covers to be medium duty to BS 497:1967 ref BS-24/78 Standard Detail DEED/G/6-1.

MANHOLE SCHEDULE				
MH No	Cover Level	Invert Level	Backdrop	Type
1	99.500	99.010		Collection Chamber
2	99.610	98.810		Existing Manhole
3	99.510	98.980		Collection Chamber
4	99.700	98.595		New Manhole on existing drain.
5	99.700	97.774	99.240	New Backdrop Manhole
6	99.629	97.604	EXTg	Existing backdrop Manhole
7	99.679	99.144		Existing manhole landscaped yard
8	99.631	97.021		As Above
9	99.679	99.127		As 7&8 however the side of the manhole when bedding will need to be checked.
10	99.600	98.790		Collection Chamber
11	99.500	98.650		Collection Chamber
12	99.550	97.425	98.610	New Backdrop Manhole on line of existing drain
13	99.445	97.335		Existing Manhole
14	99.400	97.700	98.530	New Backdrop Manhole on existing drain
15	99.400	98.650		Collection Chamber
16	99.441	98.266		Existing Manhole
17	99.500	98.380		Collection Chamber

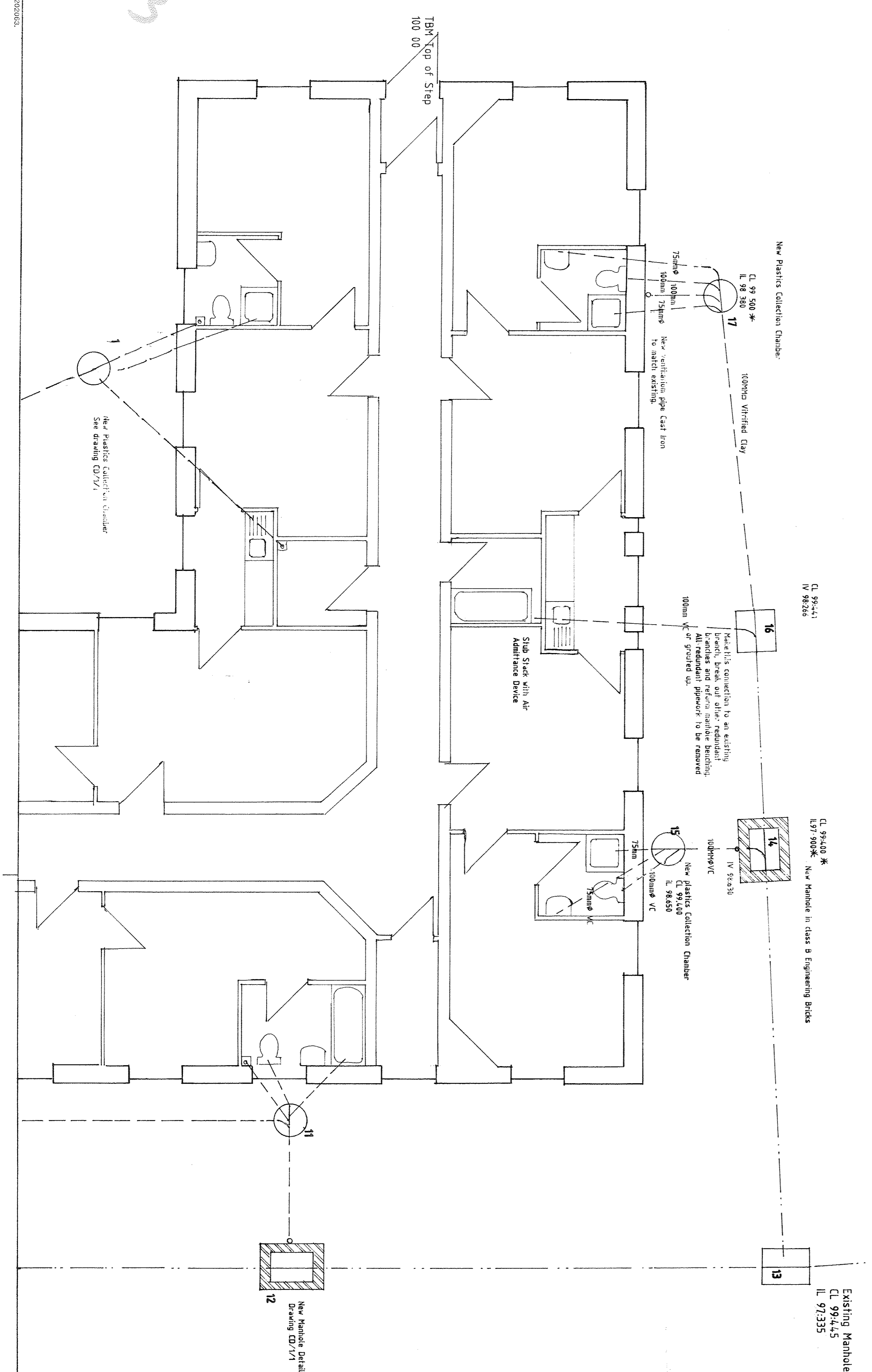

PSA
BUILDING MANAGEMENT EASTERN

Site
R. A. F. Collishall
Officers Mess

Element / Worksection
Drainage Details
Officers Mess Refurbishment

Scales
1 : 50

Office of Origin
P. S. A. Building Management
Block D Brooklands Avenue
CAMBRIDGE CB2 2DZ

Officer Responsible & Appointment
S. T. Wilson Building Surveyor

Drawn
P. J. Howell
Date
Sept 91

Checked
Date

Approved
Date

Project No.
4W/910134

Drawing No.
GMN-5/91/CD/1/2

Revision

ARCHIVED TO CD

5613