

1 04001 SECOND FLOOR - EXISTING GA PLAN  
01102 1 1:100

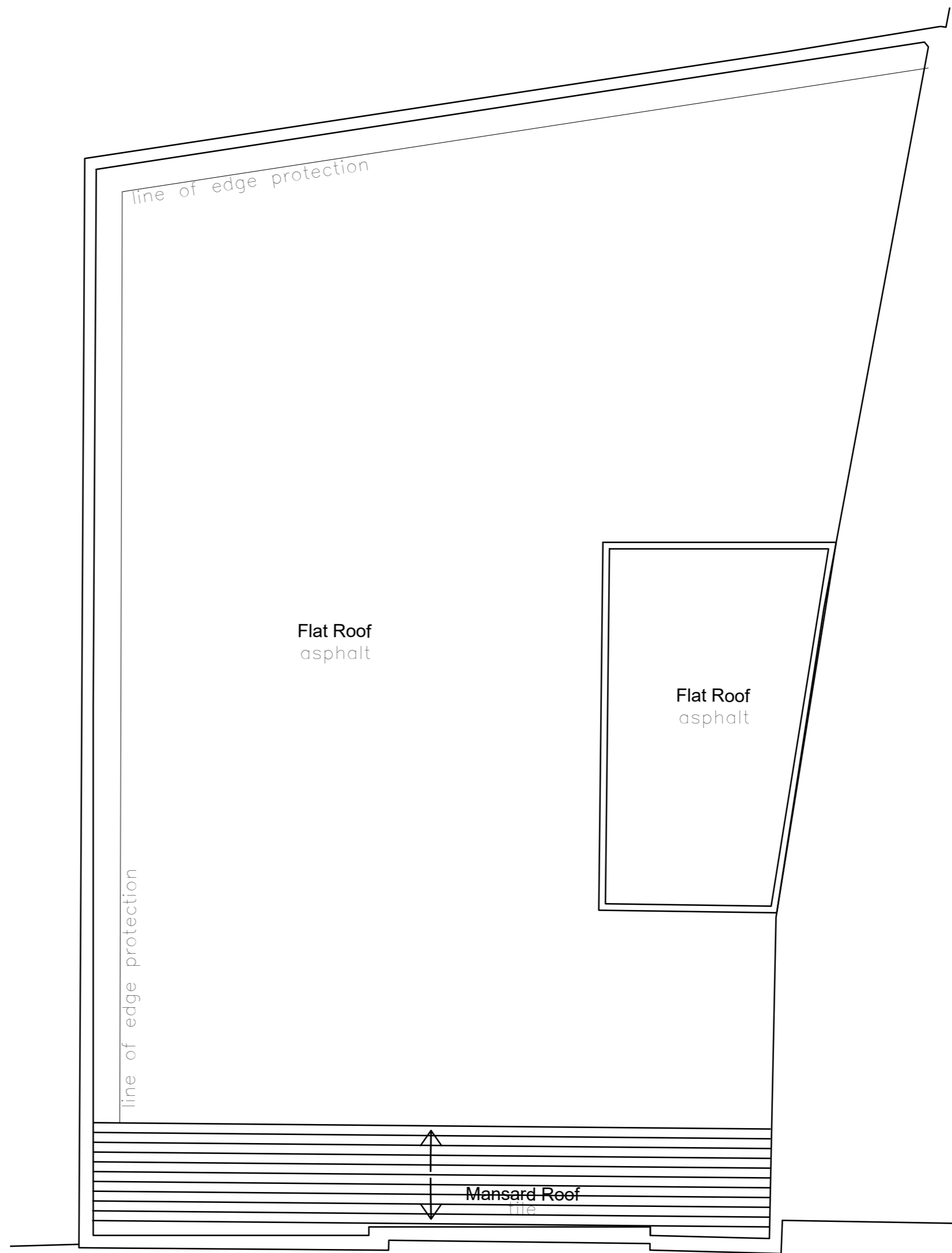

2 04001 ROOF LEVEL - EXISTING GA PLAN  
01102 1 1:100

Rev	By/Chk	Date	Description

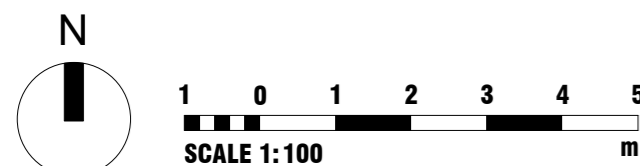

**PROJECT:** 10 LONDON ST BASINGSTOKE  
**PROJECT NO.:** 19032

**DRAWING TITLE:** EXISTING SECOND FLOOR & ROOF PLAN

**STATUS:** INFORMATION  
**PROJECT PHASE:**

**DRAWING NO.:** 19032-BAR-ZZ-DR-A-01102  
**REV.:**

**BY:** NP | **CHK:** HG | **DATE:** 22.11.2019 | **SCALE @ A2:** 1:100

**B+R ARCHITECTS**

20 Shepherdess Walk,  
London N1 7LB  
T 020 3227 0800  
E design@bandr-arch.com  
www.bandr-arch.com